

# Silicon Bridge Rectifiers

# GBL005--GBL10

## FEATURES

- Rating to 1000V PRV
- Surge overload rating to 150 Amperes peak
- Ideal for printed circuit board
- Reliable low cost construction utilizing molded plastic technique results in inexpensive product
- Lead solderable per MIL-STD-202 method 208
- Glass passivated junctions



Lead-free

## Maximum Ratings (@T<sub>A</sub> = 25°C unless otherwise specified)

Characteristic	Symbol	GBL005	GBL01	GBL02	GBL04	GBL06	GBL08	GBL10	UNITS
Maximum recurrent peak reverse voltage	V <sub>RRM</sub>	50	100	200	400	600	800	1000	V
Maximum RMS voltage	V <sub>RMS</sub>	35	70	140	280	420	560	700	V
Maximum DC blocking voltage	V <sub>DC</sub>	50	100	200	400	600	800	1000	V
Maximum average forward Output current @T <sub>A</sub> =25°C	I <sub>F(AV)</sub>	4.0							A
Peak forward surge current 8.3ms single half-sine-wave superimposed on rated load	I <sub>FSM</sub>	150.0							A

## Thermal Characteristics

Characteristic	Symbol	GBL005	GBL01	GBL02	GBL04	GBL06	GBL08	GBL10	UNITS
Typical Thermal Resistance	R <sub>θJC</sub>	6.5							°C/W
Operating junction temperature range	T <sub>J</sub>	- 55 ---- + 150							°C
Storage temperature range	T <sub>STG</sub>	- 55 ---- + 150							°C

## Electrical Characteristics (@T<sub>A</sub> = 25°C unless otherwise specified)

Characteristic	Symbol	GBL005	GBL01	GBL02	GBL04	GBL06	GBL08	GBL10	UNITS
Maximum instantaneous forward voltage @2.0A	V <sub>F</sub>	1.1							V
Maximum reverse current @T <sub>A</sub> =25°C at rated DC blocking voltage @T <sub>A</sub> =100°C	I <sub>R</sub>	5.0 500							μ A

## Silicon Bridge Rectifiers

**GBL005--GBL10**

### PACKAGE OUTLINE DIMENSIONS

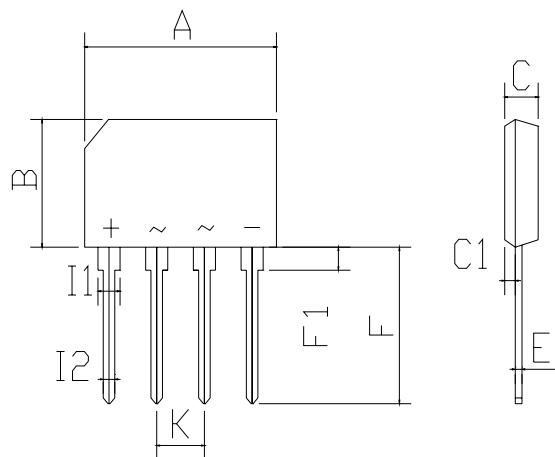

KBJ2		
Dim	Min	Max
A	19.90	20.30
B	10.90	11.30
C	3.35	3.65
C1	0.95	1.25
E	0.40	0.60
F	13.30	13.90
F1	2.20	2.80
I1	1.40	1.70
I2	1.0 Typical	
K	4.70	5.30
All Dimensions in mm		

### PACKAGE INFORMATION

Device	Package	Shipping
GBL005--GBL10	KBJ2	500 Units/Box

## Silicon Bridge Rectifiers

## GBL005--GBL10

FIG.1 – PEAK FORWARD SURGE CURRENT

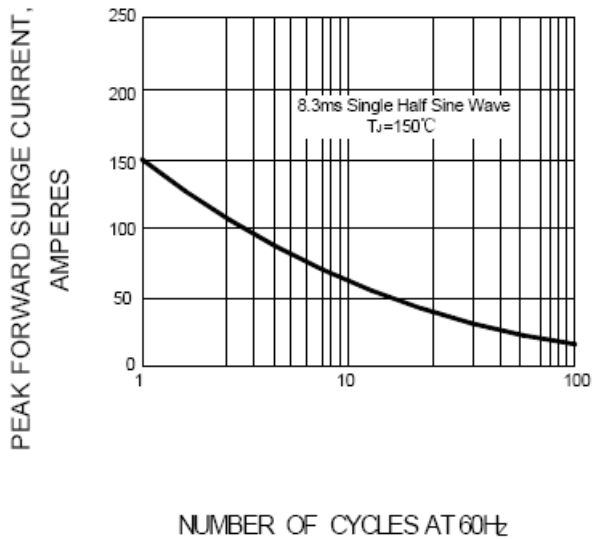

FIG.2 – FORWARD DERATING CURVE

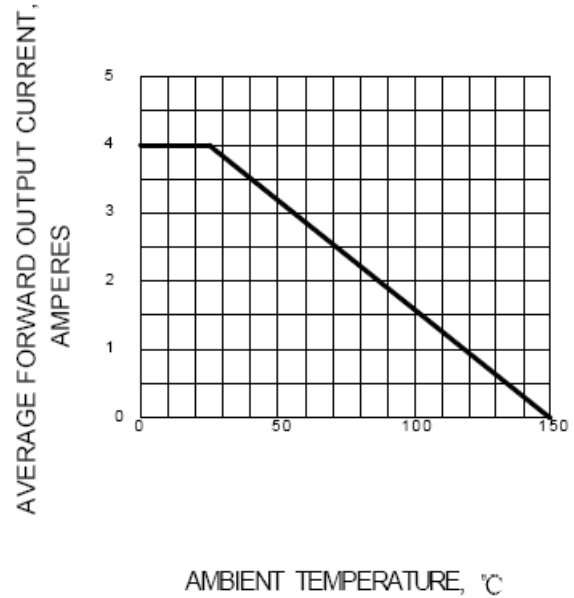

FIG.3 – TYPICAL FORWARD CHARACTERISTIC

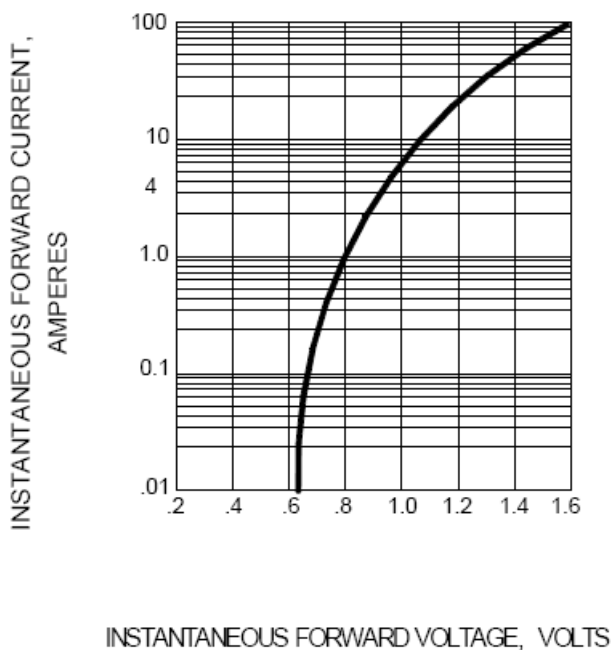

FIG.4 – TYPICAL REVERSE CHARACTERISTICS

